



, , MO -- \$2,329,000
Listing Courtesy of: Goodin Auction & Real Estate



Trammell and Son Realty

18 E. Vine Street
Dexter, MO 63841
573-624-5538 • Fax: 573-624-4241
info@trammellandson.com
<http://www.trammellandson.com>

Acres: 274

County Taxes:

Cropland: Yes

Pasture: No

Water: Other

Waste: Other

Woods: No

Hill Land: No

Graded: No

Irrigated: Yes

Flood Zone: No

Zoning: agriculture

County: New Madrid

School: New Madrid

Rural: Yes

Great investment opportunity. 274 acres of good row crop land. Produces corn, soy beans and wheat. Locally know as the Curtis Farm. On County Rd 820, New Madrid County. Section 23 Township 25 N Range 14 E. 2 - 7 tower pivots. \$8500 an acre.

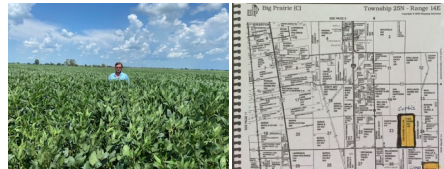

Information deemed reliable but not guaranteed, all rights reserved by SemoMLS.com